



KUMPLAST

synergy of materials



BRIZGANI IZDELKI

INJECTION MOULDED PRODUCTS • SPRITZGUß PRODUKTE • PRODOTTI STAMPATO AD INIEZIONE



BRIZGANJE PLASTIKE

Brizganje plastike je lahko zelo dinamična dejavnost, saj skrbimo za nenehen razvoj novih orodij za nove izdelke glede na želje naših kupcev. Vaše ideje in potrebe združujemo z našim znanjem in izkušnjami, skupaj z vami ustvarjamo dovršene izdelke.

PLASTIC INJECTION MOULDING

Plastic injection moulding can be very dynamic process, we care for constantly development of new tools for new products considering needs of our customers. We unite your ideas and needs with our knowledge and experiences and we create new products together with our customers.

EKSTRUZIJA, KOEKSTRUZIJA

Pri nas dobite široko paletu ekstrudiranih izdelkov, ki jo dopolnjujemo z vedno novimi izdelki, saj smo odprti za vaše predloge. Tehnologija nam omogoča kokstrudiranje izdelkov, prav tako lahko vse vrste profilov preoblečemo v imitacijo lesa.

EXTRUSION, COEXTRUSION

In our company you can find wide offer of extruding products which is constantly superstructure, we are always opened for all your suggestions. Technology also provides coextrusion of products, we can change all sorts of profiles in imitation of wood or stone.

KOVINSKA GALANTERIJA

Vzporedno z razvojem plastičnih izdelkov nadgrajujemo dejavnost kovinske galanterije.

METAL STAMPING

At the same time with development of plastic products we superstructure production of progressive metallal stamping.

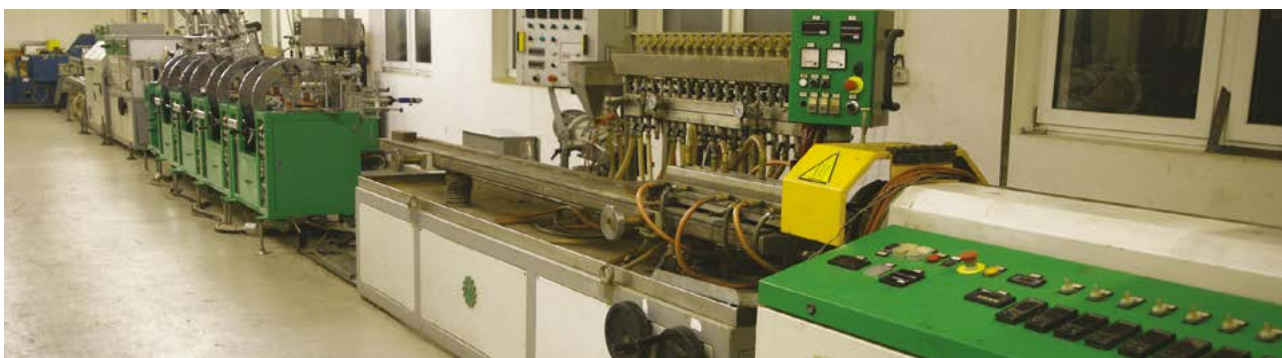
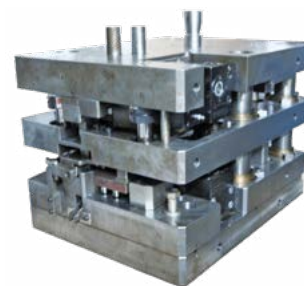

POHIŠTVENE NOGE • FURNITURE FEET • ANSTELLBARE FÜSSE •
 PIEDINI PER MOBILI

REGULIRNE NOGE • ADJUSTABLE FEET • ANSTELLBARE FUSSE • PIEDINI REGOLABILI



434100

DØ	10 mm
A	64 mm
B	64 mm
H_{min}	90 mm
H_{max}	125 mm



h

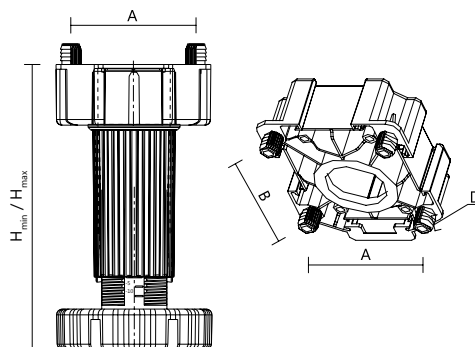

434150

DØ	10 mm
A	64 mm
B	64 mm
H_{min}	135 mm
H_{max}	175 mm



h

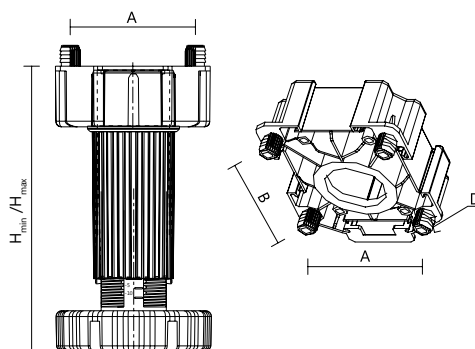

434200

DØ	10 mm
A	64 mm
B	64 mm
H_{min}	180 mm
H_{max}	220 mm



h

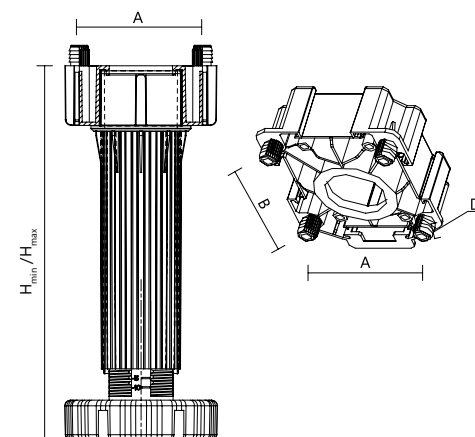

POHIŠTVENE NOGE • FURNITURE FEET • ANSTELLBARE FÜSSE •
 PIEDINI PER MOBILI

REGULIRNE NOGE • ADJUSTABLE FEET • ANSTELLBARE FÜßE • PIEDINI REGOLABILI



424100

DØ	4,2 mm
A	60 mm
B	36 mm
H_{min}	90 mm
H_{max}	125 mm

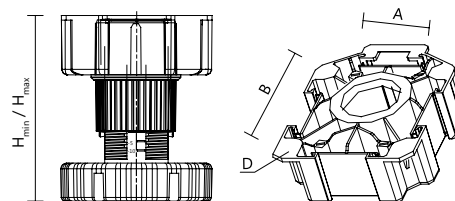

424150

DØ	4,2 mm
A	60 mm
B	36 mm
H_{min}	135 mm
H_{max}	175 mm

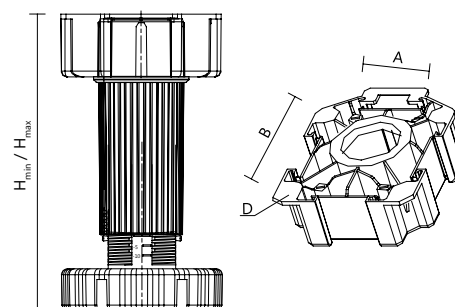

424200

DØ	4,2 mm
A	60 mm
B	36 mm
H_{min}	180 mm
H_{max}	220 mm

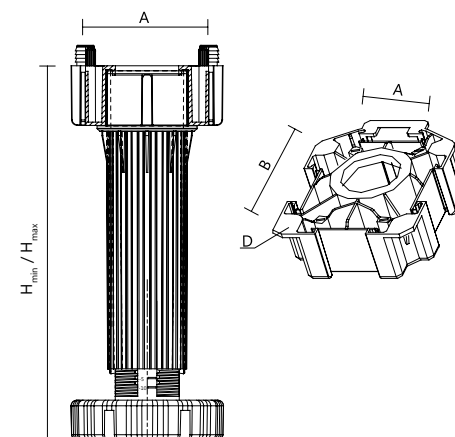

POHIŠTVENE NOGE • FURNITURE FEET • ANSTELLBARE FÜSSE •
 PIEDINI PER MOBILI

REGULIRNE NOGE • ADJUSTABLE FEET • ANSTELLBARE FUSSE • PIEDINI REGOLABILI



418400

D(Φ)	5 mm
A	18 mm
B	60 mm
H min	200 mm
H max	330 mm

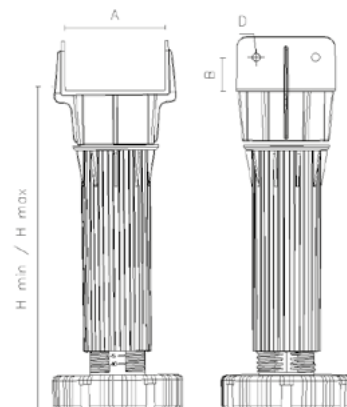

424000

L	50 mm
B	4 mm
DØ	40 mm
H	60 mm

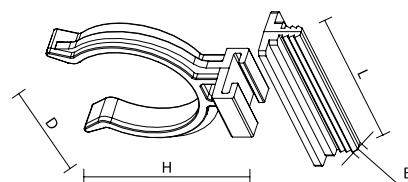

424010

L	50 mm
D₁	4 mm
DØ	40 mm
H	60 mm

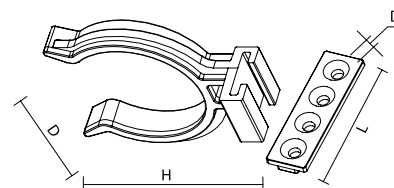

424030

H	60 mm
DØ	40 mm

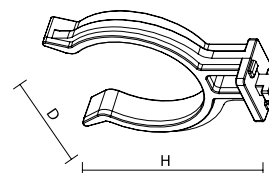

POHIŠTVENE NOGE • FURNITURE FEET • ANSTELLBARE FÜSSE •
 PIEDINI PER MOBILI

REGULIRNE NOGE • ADJUSTABLE FEET • ANSTELLBARE FÜSSE • PIEDINI REGOLABILI



424020

L	13 mm
L₁	14 mm
L₂	16 mm
L₃	18 mm



h

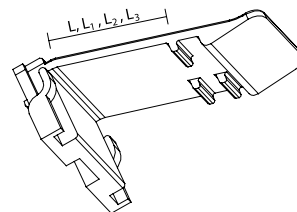

464912

DØ	48 mm
D₁Ø	4 mm
L	32 mm
H_{max}	115 mm
H_{min}	95 mm



a h

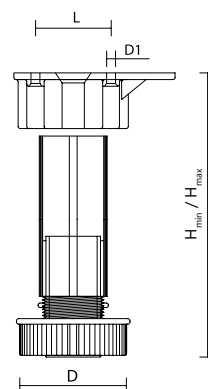

494000

DØ	48 mm
D₁Ø	4 mm
L	32 mm
H_{max}	160 mm
H_{min}	98 mm



a h

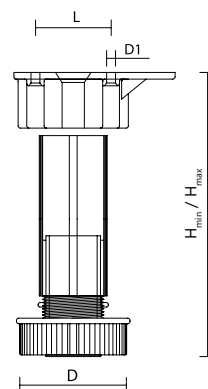

464916

DØ	48 mm
D₁Ø	4 mm
H₁	32 mm
H_{max}	165 mm
H_{min}	145 mm



a h

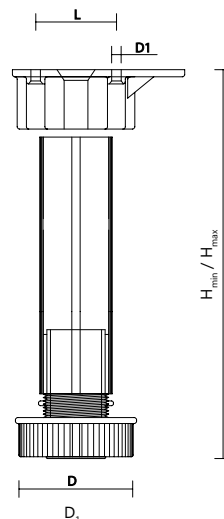

POHIŠTVENE NOGE • FURNITURE FEET • ANSTELLBARE FÜSSE •
 PIEDINI PER MOBILI

REGULIRNE NOGE • ADJUSTABLE FEET • ANSTELLBARE FUSSE • PIEDINI REGOLABILI



464900

DØ	48 mm
D₁Ø	25 mm
H₁	13 mm
H_{max}	115 mm
H_{min}	95 mm

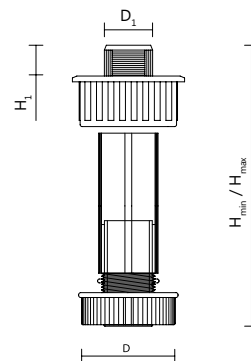

473379

DØ	48 mm
D₁Ø	25 mm
H₁	13 mm
H_{max}	165 mm
H_{min}	145 mm

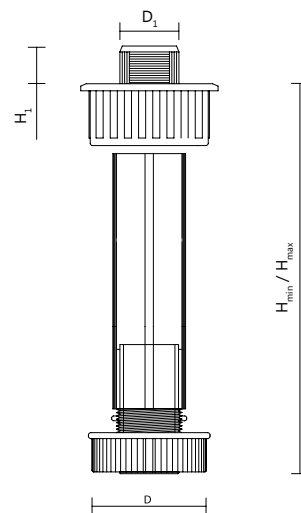

464998

DØ	48 mm
D₁Ø	15 mm
H₁	12 mm
H_{max}	115 mm
H_{min}	95 mm

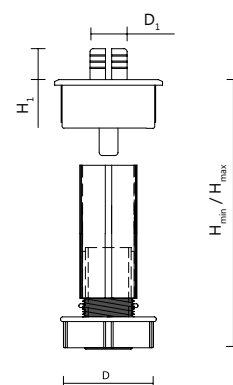

POHIŠTVENE NOGE • FURNITURE FEET • ANSTELLBARE FÜSSE •
 PIEDINI PER MOBILI

REGULIRNE NOGE • ADJUSTABLE FEET • ANSTELLBARE FÜBE • PIEDINI REGOLABILI



464999

DØ	48 mm
D₁Ø	15 mm
H₁	12 mm
H_{max}	165 mm
H_{min}	145 mm

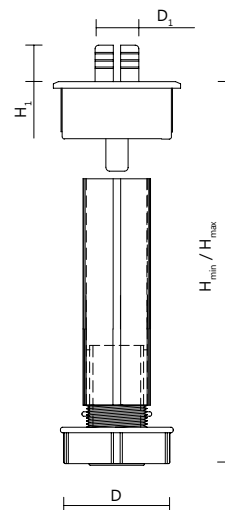

464300

DØ	48 mm
H	20 mm
H₁	16 mm

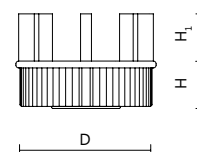

464200

DØ	29 mm
H	45 mm
H₁	40 mm
H₂	53 mm

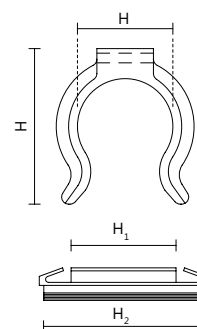

464201

DØ	29 mm
D₁Ø	4,2 mm
H	45 mm
L	45 mm

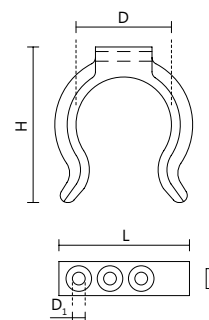

POHIŠTVENE NOGE • FURNITURE FEET • ANSTELLBARE FÜSSE •
 PIEDINI PER MOBILI

REGULIRNE NOGE • ADJUSTABLE FEET • ANSTELLBARE FUSSE • PIEDINI REGOLABILI



464202

DØ 29 mm

H 45 mm

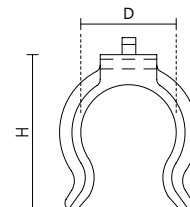

464105

DØ 20 mm

D₁Ø M10 mm

H 35 mm

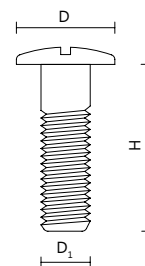

	A	B	D₁	L
454060	45	45	32	60
454080	45	45	32	80
454100	45	45	32	100
454120	45	45	32	120
454140	45	45	32	140
454150	45	45	32	150
454160	45	45	32	160
454180	45	45	32	180
454200	45	45	32	200

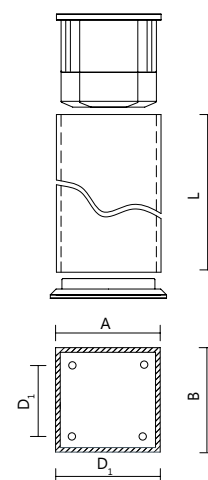

®

POHIŠTVENE NOGE • FURNITURE FEET • ANSTELLBARE FÜSSE •
 PIEDINI PER MOBILI

REGULIRNE NOGE • ADJUSTABLE FEET • ANSTELLBARE FÜSSE • PIEDINI REGOLABILI



150604

DØ	32 mm
D₁Ø	M6
H₁	~
D₂	M6
H	~

Ⓡ

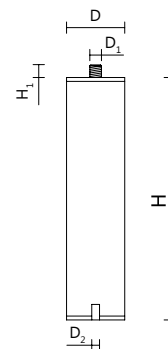

321645

DØ	32 mm
H	16,5 mm
D₁Ø	4,5 mm

●
h

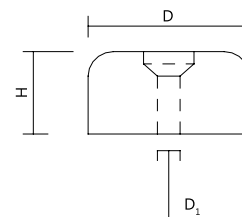

757540

A	75 mm
B	75 mm
H	40 mm

Ⓡ

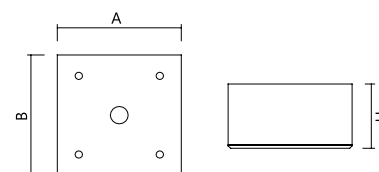

601525

A	150 mm
B	60 mm
H	25 mm
D₁	4,5 mm

Ⓡ

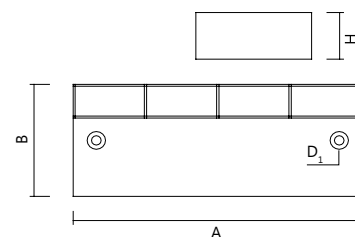

POHIŠTVENE NOGE • FURNITURE FEET • ANSTELLBARE FÜSSE •
 PIEDINI PER MOBILI

REGULIRNE NOGE • ADJUSTABLE FEET • ANSTELLBARE FUSSE • PIEDINI REGOLABILI



464000

DØ	50 mm
D₁Ø	45 mm
B	M8, M10
H_{max}	125 mm
H_{min}	117 mm

Ⓜ

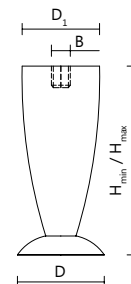

677214

DØ	5 mm
H	125 mm
H₁	32 mm
A	63 mm
B	35 mm

Ⓜ

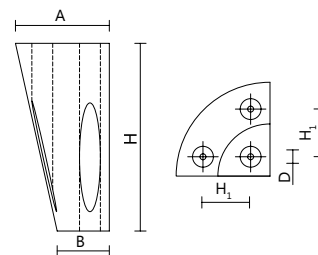

464040

DØ	56 mm
D₁Ø	42 mm
B	32 mm
H_{min} / H_{max}	~

Ⓜ

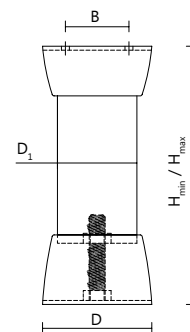

NOSILCI • AUFHÄNGERS • REGGIPENSILE

OBEŠALNI MEHANIZMI VISEČIH ELEMENTOV • ADJUSTABLE SUPPORTS OF CABINET HANGERS • AUFHÄNGERS • REGGIPENSILE REGOLABILE



448000

A	32 mm
B	35 mm
L	52 mm
DØ	7 mm
D₁Ø	4,7 mm

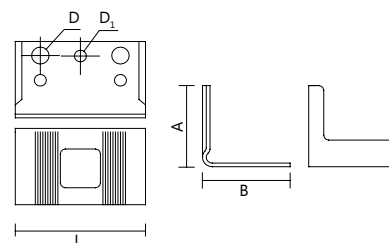

458715

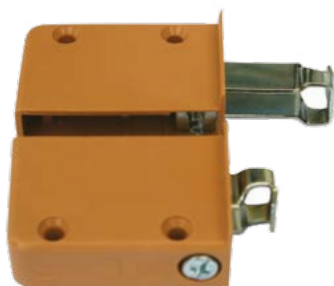
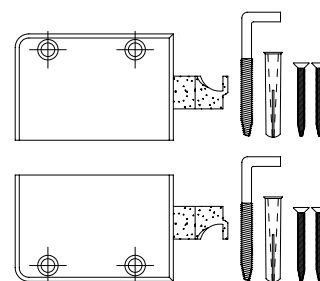

458701 desni • right • recht • destra

DØ	4,5 mm
A	39 mm
B	59 mm
H₁	15 - 30 mm
L_{min} / L_{max}	10 - 25 mm

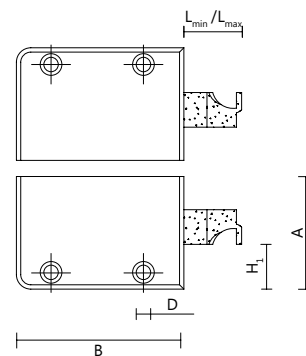

458700 levi • left • link • sinistra



438750

B	70 mm
A	35 mm
C	18 mm

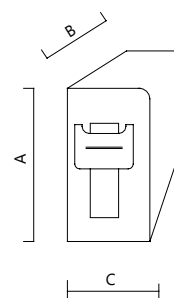

NOSILCI • AUFHÄNGERS • REGGIPENSILE

OBEŠALNI MEHANIZMI VISEČIH ELEMENTOV • ADJUSTABLE SUPPORTS OF CABINET HANGERS •
AUFHÄNGERS • REGGIPENSILE REGOLABILE

458749

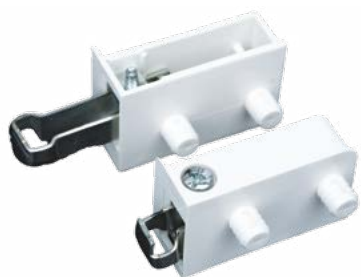

A	39 mm
B	61 mm
L_{min} / L_{max}	15 - 30 mm
H₂	23 mm
L₃	20 mm
DØ	10 mm
L₄	11 mm
L	32 mm
L_{min1} / L_{max2}	8 - 25 mm

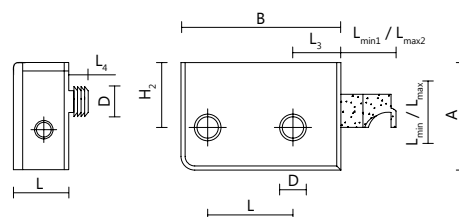

438750



A	32 mm
B	60 mm
L_{min} / L_{max}	15 - 30 mm
H₂	23 mm
L₁	20 mm
DØ	10 mm
L	32 mm
L_{min1} / L_{max1}	8 - 25 mm

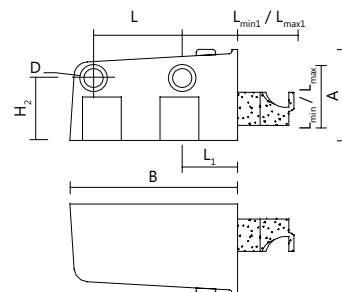

458710



A	44 mm
B	58 mm
L_{min} / L_{max}	15 - 26 mm
H₂	16 mm
L₃	17 mm
DØ	4 mm
L	32 mm
L_{min1} / L_{max1}	20 - 35 mm

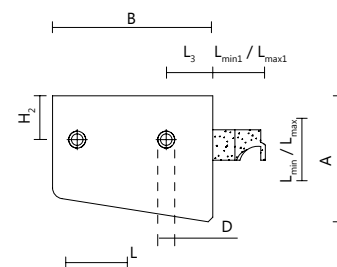

NOSILCI • AUFHÄNGERS • REGGIPENSILE

**OBEŠALNI MEHANIZMI VISEČIH ELEMENTOV • ADJUSTABLE SUPPORTS OF CABINET HANGERS •
AUFHÄNGERS • REGGIPENSILE REGOLABILE**

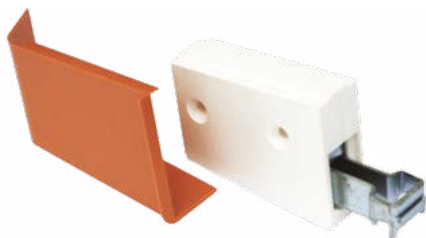

458790

B 76 mm

A 46 mm

C 20 mm

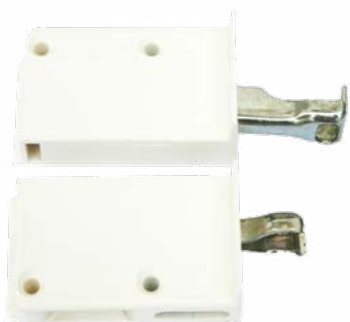
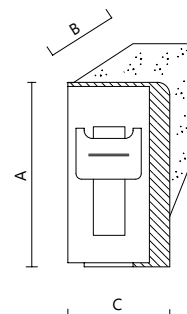

458730 levi • left • link • sinistra

A 39 mm

B 64 mm

L_{min} / L_{max} 16 - 30 mm

H₂ 31 mm

L₃ 24 mm

DØ 4 mm

L 32 mm

L_{min1} / L_{max1} 8 - 28 mm

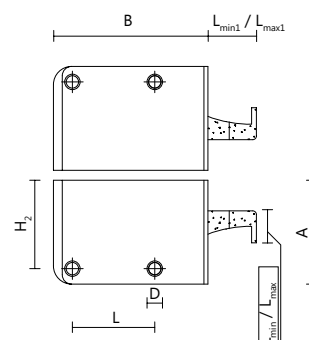

458731 desni • right • recht • destra

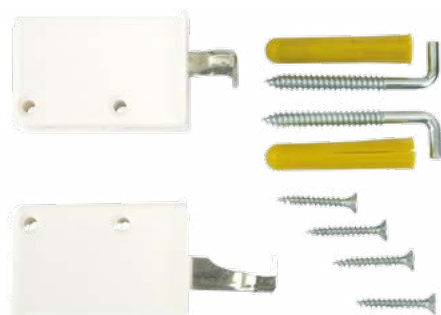

458735 komplet • complete • komplett • completo

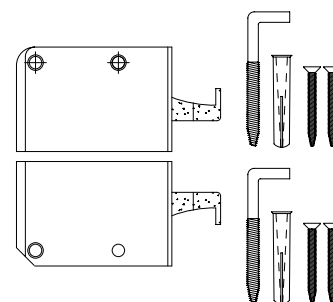



458780

H	48 mm
L	2000 mm
D ₁	10 mm
L ₁	50 mm

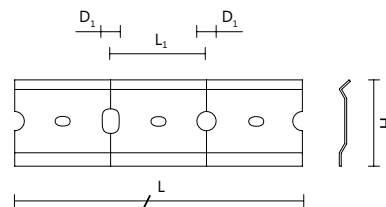

458800

L	130 mm
L ₁	48 mm
H	25 mm

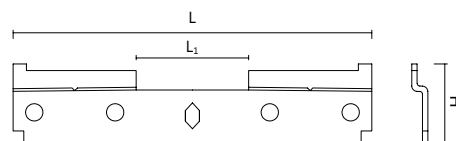

506016

DØ	6 mm
D ₁ Ø	5 mm
H	16 mm
H ₁	7,5 mm

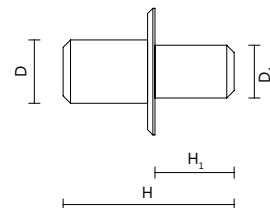

506012

DØ	5 mm
H	17 mm
H ₁	7,5 mm

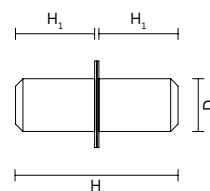

	DØ	L
502400	5 mm	25 mm
502401	5 mm	50 mm

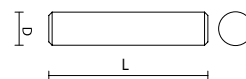

501700

DØ	5 mm
H	15 mm
L	9 mm
L ₁	8 mm

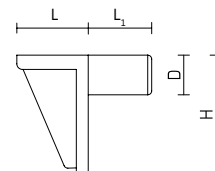

NOSILCI • AUFHÄNGERS • REGGIPENSILE

NOSILCI POLIC, PALIC • SHELF & TUBE SUPPORTS • SCHRANK & TRAGBOLZEN • REGGIPIANO, REGGITUBO



130190

A	13 mm
L	12 mm
L₁	7,5 mm

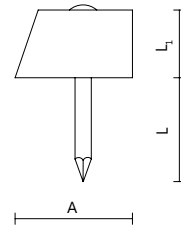

506018



DØ	5 mm
A	25 mm
B	20 mm
L₁	12 mm
L₂	8 mm
H₁	10 mm
T₁	2 - 5 mm

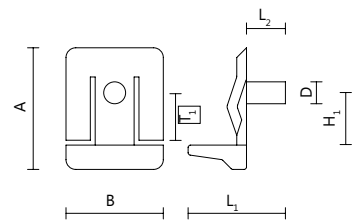

506017



DØ	5 mm
A	37 mm
B	17 mm
L₁	8,5 mm
L₂	8 mm
H₁	4 mm
T₁	16,8 mm

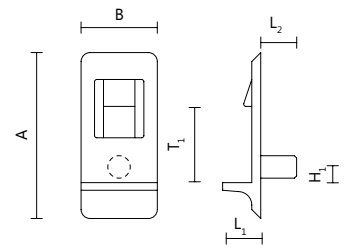

202433



DØ	20 mm
D₁	3 mm
A	34 mm
H₁	12 mm

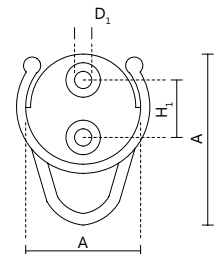

	DØ	H	A	B
243000	3,5 mm	3 mm	5 mm	24 mm
244000	3,5 mm	5 mm	5 mm	24 mm

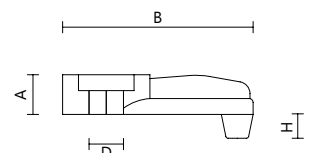

NOSILCI • AUFHÄNGERS • REGGIPENSILE

DRSNIKI • GLIDERS • GLEITTEILE • PLANARE



593213

DØ	8 mm
B	9 mm
H₁	4 mm
A	58 mm
L₁	32 mm

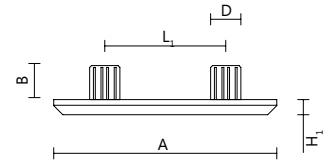

	DØ	D₁Ø	B	H₁
148014	15 mm	8 mm	13 mm	4 mm
148011	15 mm	8 mm	10 mm	4 mm

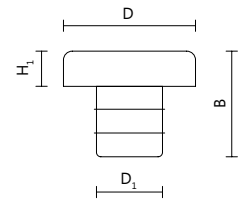

	DØ	B	H₁
151210	16 mm	16 mm	9 mm
151216	16 mm	23 mm	16 mm

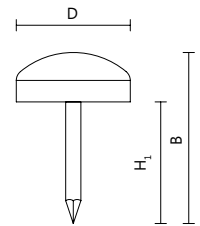

	DØ	H
131208	16 mm	8 mm
131210	16 mm	10 mm
131212	16 mm	12 mm

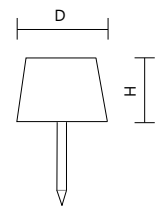

	A	B	H
231210	15 mm	45 mm	10 mm
231212	15 mm	45 mm	12 mm
231213	15 mm	45 mm	13 mm
231215	15 mm	45 mm	15 mm

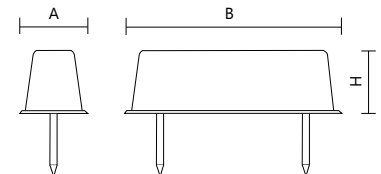

950020

DØ	15 mm
B	13 mm

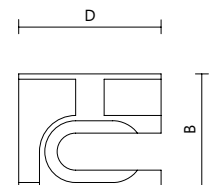

KOTNIKI • BRACKETS • ECKVERBINDER • ANGOLARE

KOTNIKI, KOTNIKI S POKROVOM • BRACKETS, BRACKETS WITH COVER CAP • ECKVERBINDER, ECKVERBINDER MIT ABDECKKAPPE • ANGOLARE, ANGOLARE CON COPERTURA

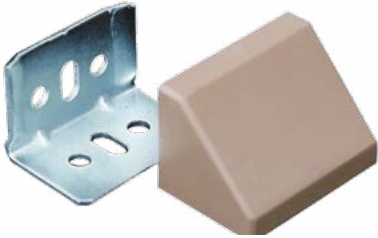

223022

DØ	4 mm
D₁	4 mm
B	20 mm
A	30 mm

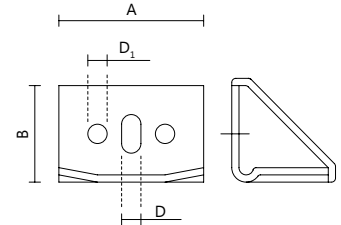

565222

DØ	7 mm
B	50 mm
A	42 mm
L₁	26 mm

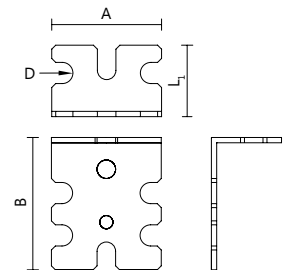

475724

DØ	8 mm
B	44 mm
A	25 mm
L₁	26 mm
A₁	19 mm
B₁	12,5 mm

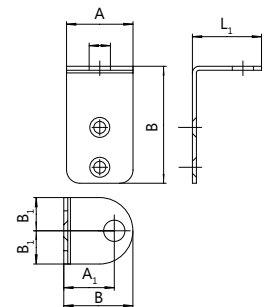

202044

H	20 mm
H₁	4,5 mm
H₂	44 mm
D	16 mm
L	20 mm
L₁	6,5 mm

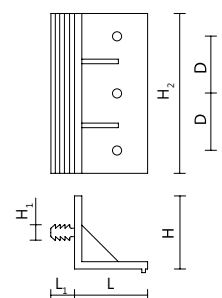



202020

DØ	4,5 mm
B	20 mm
A	20 mm
A₁	13,5 mm
H	15 mm

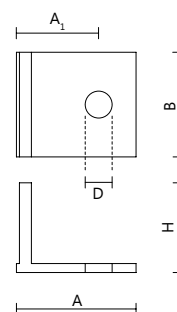

473480

DØ	4,5 mm
B	25 mm
B₁	12 mm
A	50 mm
A₁	25 mm
L	32 mm

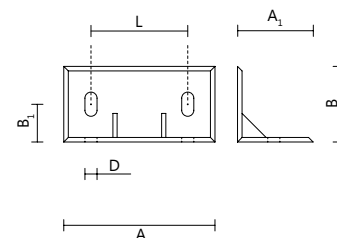

467104

DØ	5 mm
B	12 mm
A	90 mm
L₁	32 mm

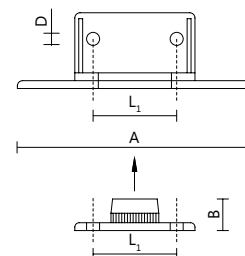

457000

DØ	10 mm
B	22 mm
A	48 mm
H₁	12 mm

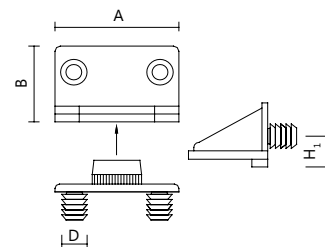

	H	B	D(Φ)	A
472080	8 mm	20 mm	5,2 mm	47 mm
472052	5,2 mm	20 mm	5,2 mm	47 mm
472027	2,7 mm	20 mm	5,2 mm	47 mm

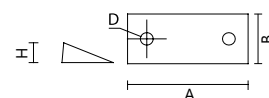



148248

A	19 mm
B	14 mm
H	7 mm
DØ	3 mm

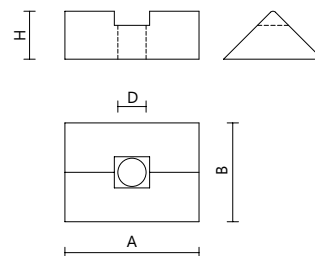

501340

A	19 mm
B	81 mm
H₁	19 mm

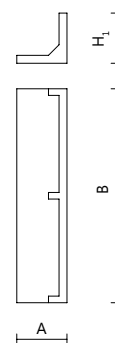

456903

DØ	8 mm
B	35 mm

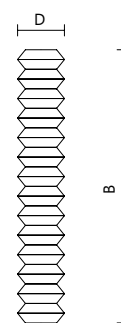

858290

DØ	8,5 mm
B	19 mm
B₁	9 mm
A	5 mm

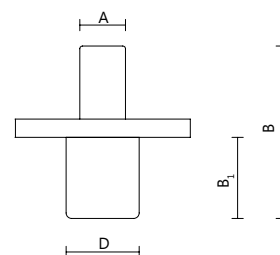



	DØ	D₁Ø	H_{max}	H_{min}
501412	16 mm	8 mm	38 mm	30 mm
501416	16 mm	8 mm	44 mm	36 mm

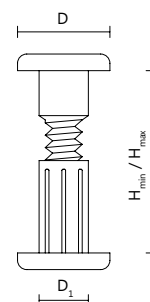
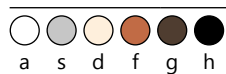

419510

D₁Ø	19,5 mm
DØ	20 mm
L_{min} / L_{max}	13 - 19 mm

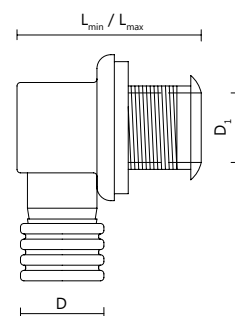



478841

D 62 mm

D₁ 47 mm

A 17 mm

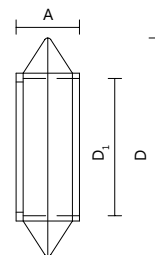

588040

H 7,5 mm

B 58 mm

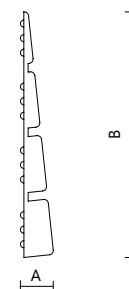

376102

B 48 mm

H₁ 4 mm

H₂ 38 mm

A 18,5 mm

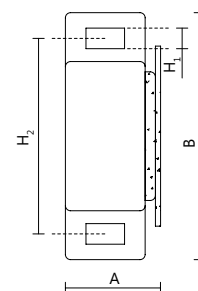

506460

A 11,5 mm

B₁ 16,3 mm

B 15 mm

A₁ 9,2 mm

B₂ 4,5 mm

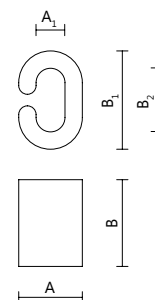

206045

DØ 20 mm

D₁Ø 6 mm

B 4,5 mm

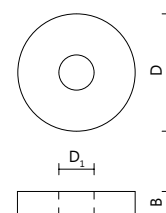



999991

DØ	24 mm
D₁Ø	4,5 mm
A	50 mm
B	56 mm
B₁	39 mm
H₁	23 mm
H₂	16 mm



h

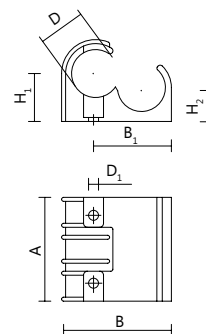

999992

DØ	24 mm
A	24 mm
L	88 mm
L₁	60 mm



h

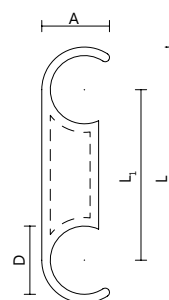

999990

DØ	4,8 mm
A	35 mm
B	25 mm
L	72 mm



h

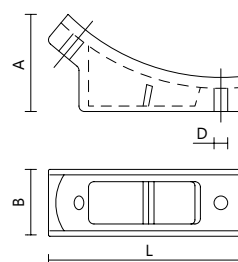



996988

A	26 mm
A₁	21,5 mm
B	41 mm
B₁	36,5 mm
H	19,5 mm
H₁	5,5 mm



h

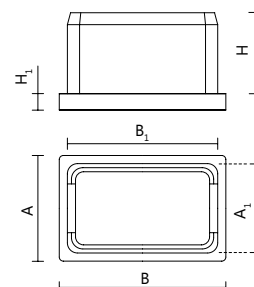

999989

DØ	25 mm
D₁Ø	22,8 mm
H	18 mm
H₁	6 mm



h

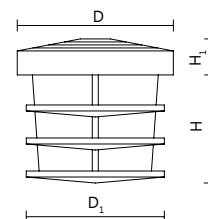

503632

DØ	5 mm
D₁Ø	6 mm
D₂Ø	3 mm
A	39 mm
B	32 mm



a s d f g h

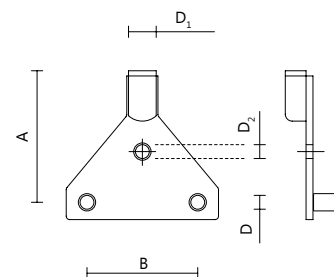

860720

DØ	5 mm
A	64 mm
B	22 mm
H₁	11 mm



h

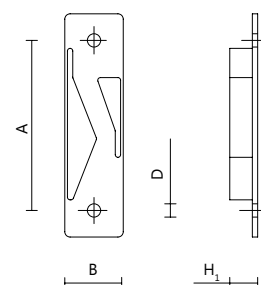



481855

DØ 12 mm

D₁Ø 4 mm

A 15 mm

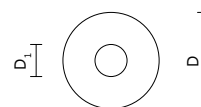
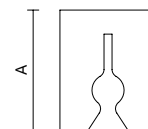

322558

A 25 mm

A₁ 8 mm

B 32 mm

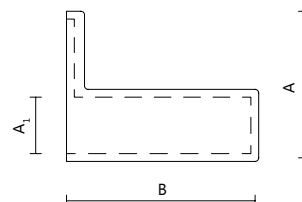

594253

DØ 19 mm

D₁Ø 6,1 mm

A 38 mm

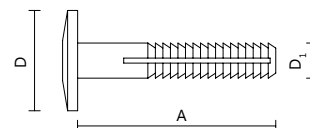

058015

A 50 mm

B 50 mm

H 25 mm

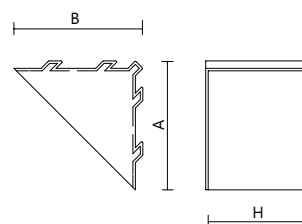



058025

A	55 mm
B	55 mm
H	39 mm

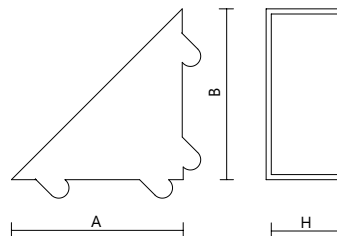

058019

A	56 mm
B	56 mm
H	19 mm

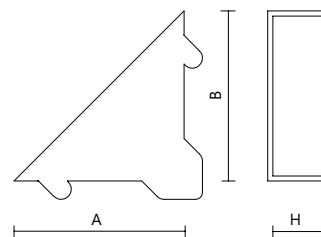

058040

A	60 mm
B	60 mm
H	27 mm

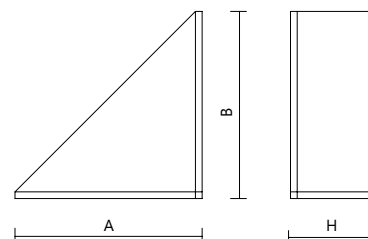

ROČAJI • HANDLES • GRIFFE • MANIGLIA

ROČAJI • HANDLES • GRIFFE • MANIGLIA



488400

D(Φ)	5 mm
B	18 mm
A	60 mm
H min	200 mm
H max	330 mm

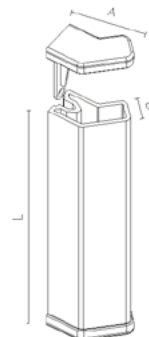
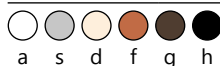

470033

A	74 mm
A₁	32 mm
B	19 mm
DØ	2,7 mm
H	30 mm

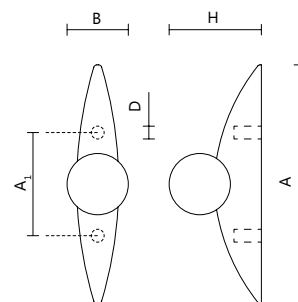

641280

A	127 mm
A₁	64 mm
DØ	2,7 mm
H	40 mm

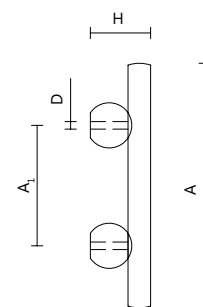

961530

A	153 mm
A₁	96 mm
DØ	4 mm
H	26 mm

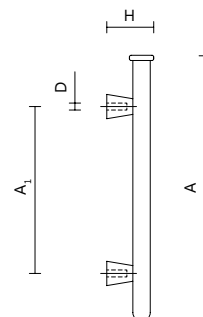

DEKORATIVNI ELEMENTI • DECORATIVE ELEMENTS • DEKOR ELEMENTE •
ELEMENTI DEKORATIVI

OKRASNE LETVICE, POKROV • DECORATIVE LATHS, COVER • DEKORLEISTEN, DECKEL •
ASSICELLE, COPERTURA



	A	A ₁	DØ	D ₁ Ø
647416	73 mm	64 mm	4 mm	10 mm
962716	106 mm	96 mm	4 mm	10 mm

a s d f g h

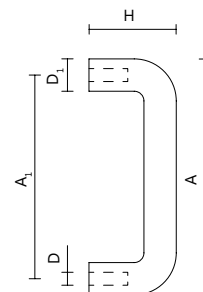

	B	L
222147	20 mm	147 mm
222297	20 mm	297 mm
222361	20 mm	361 mm
222397	20 mm	397 mm
222447	20 mm	447 mm
222597	20 mm	597 mm

Cr

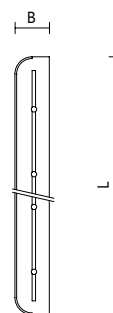

	B	L
111297	21 mm	297 mm
111397	21 mm	397 mm
111447	21 mm	447 mm
111597	21 mm	597 mm

Cr



999220	
DØ	3 mm
D ₁ Ø	14 mm
B	6 mm
L	160 mm
H	34 mm
H ₁	28,3 mm

R

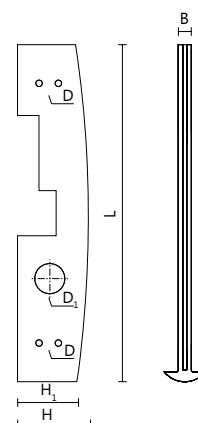

POKRIVNE KAPICE • COVER CAPS • ABDECKKAPEN • TAPPO

RAZNE POKRIVNE KAPICE • VARIOUS COVER CAPS • VERSCHIEDENE ABDECKKAPEN • TAPPO



	DØ	L	A
248594	15 mm	34 mm	10 mm
248592	21 mm	397 mm	10 mm

a
 s
 d
 f
 g
 h



Ordering code: ABS code (8xxxxx)/D

D (fi)	H
14	0,4
20	0,4

a
 s
 d
 f
 g
 h

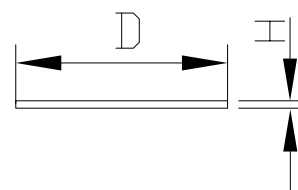

** delivered in same decors as edgebandings



	DØ	D ₁ Ø	H	H ₁
143040	4 mm	14 mm	4 mm	1,5 mm
183040	3 mm	18 mm	4 mm	2,5 mm
143050	3 mm	14 mm	5 mm	1,5 mm
144125	4,1 mm	14 mm	2,5 mm	1,5 mm
144140	4,1 mm	14 mm	4 mm	1,5 mm
144150	4,1 mm	14 mm	5 mm	1,5 mm
184125	4,1 mm	18 mm	2,5 mm	2,5 mm
184140	4,1 mm	18 mm	4 mm	2,5 mm
184150	4,1 mm	18 mm	5 mm	2,5 mm
145065	5 mm	14 mm	6 mm	1,5 mm
146550	6,5 mm	14 mm	4 mm	1,5 mm
146551	6,5 mm	18 mm	4 mm	2,5 mm
146552	6,5 mm	14 mm	5 mm	1,5 mm
148050	8 mm	14 mm	5 mm	1,5 mm
141065	10 mm	14 mm	6 mm	1,5 mm
161265	12 mm	16 mm	6 mm	2,0 mm

a
 s
 d
 f
 g
 h

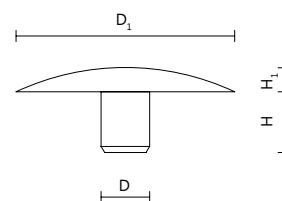

POKRIVNE KAPICE • COVER CAPS • ABDECKKAPEN • TAPPO

RAZNE POKRIVNE KAPICE • VARIOUS COVER CAPS • VERSCHIEDENE ABDECKKAPEN • TAPPO



	DØ	D ₁ Ø	H	H ₁
181465	14 mm	18,5 mm	6,5 mm	3 mm
181565	15 mm	18,5 mm	5 mm	3 mm

○ ○ ○ ● ● ●
a s d f g h

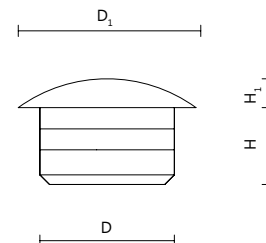

181485

DØ	14 mm
D ₁ Ø	18,5 mm
H	8,5 mm
H ₁	3 mm

○ ○ ○ ● ● ●
a s d f g h

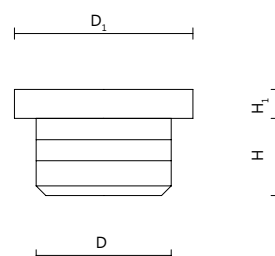

	DØ	D ₁ Ø	H	H ₁
191650	16 mm	19 mm	5 mm	2 mm
252525	25 mm	27,5 mm	6 mm	1,8 mm

○ ○ ○ ● ● ●
a s d f g h

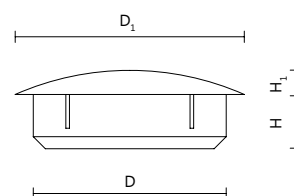

113015

A	4,5 mm
D ₁ Ø	11,5 mm
H	2,5 mm
H ₁	2 mm

○ ○ ○ ● ● ●
a s d f g h

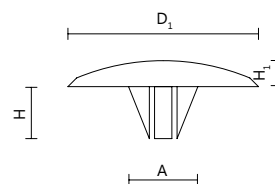

POKRIVNE KAPICE • COVER CAPS • ABDECKKAPEN • TAPPO

RAZNE POKRIVNE KAPICE • VARIOUS COVER CAPS • VERSCHIEDENE ABDECKKAPEN • TAPPO



	DØ	A	H	H ₁
291075	29 mm	9,5 mm	1,5 mm	7,5 mm
291105	29 mm	9,5 mm	1,5 mm	10,5 mm

a s d f g h

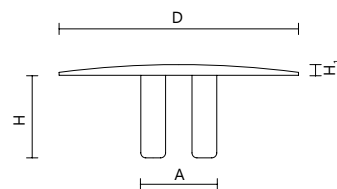

184180

DØ	5 mm
D₁Ø	6,5 mm
H	6 mm
H₁	2 mm

a s d f g h

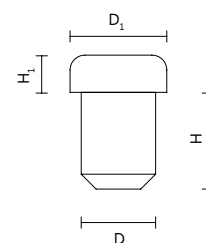

	DØ	D ₁ Ø	H	H ₁
472461	5 mm	2 - 3 mm	7,5 mm	1,5 mm
472463	9 mm	3,5 - 5,5 mm	10,5 mm	1,5 mm

a s d f g h

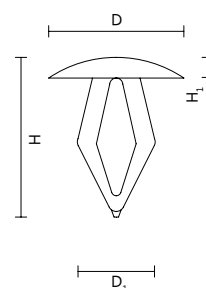

	D	D1	L
SX14	14 mm	10 - 12 mm	70 mm
SX12	12 mm	8 - 10 mm	60 mm
SX10	10 mm	6 - 8 mm	50 mm
SX8	8 mm	4,5 - 6 mm	40 mm
SX6	6 mm	4 - 5 mm	30 mm
SX5	5 mm	3 - 4 mm	25 mm

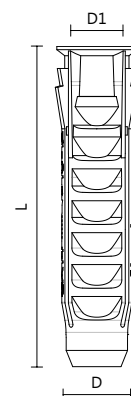

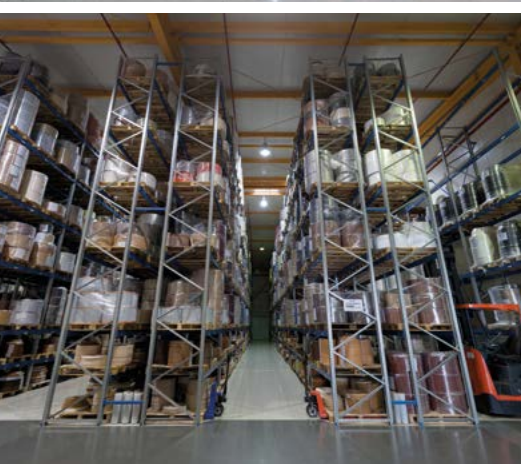

NOTES



KUM-PLAST d. o. o.

Headquarters: Prešernova 1, SI - 1410 Zagorje ob Savi, Slovenia

Production Plant: Loke 11/A, SI - 1412 Kisovec, Slovenia

Tel: + 386(0)828 04 600, + 386(0) 356 69 611, Fax: + 386(0)356 64 330

E-mail: info@kumplast.si, www.kumplast.si